



art metal

F.P.H. Art Metal Sp.j.

83-331 Przyjaźń, Łapino Kartuskie 34, Poland

Tel. 0048 58 681 80 78, Fax: 0048 58 681 80 64

www.art-metal.pl e-mail: biuro@art.-metal.pl

22 SATURN LED

Construcion:

The unit consists of a metal basket (1) holding a shade (2). A disk (4) separating electrical compartment from lighting compartment is attached to a luminary cover (3) on the top. A LED light source radiator (6) is mounted to the disk (4). CHIP LED module is mounted to the radiator (6) a tightly closed with a lens (5). Module is powered with a voltage power supply (7). The luminary cover (4) is mounted to the luminary body (1) with a hinge and closed with a screw so no additional tools are necessary. The luminary is sealed with a gasket (8).

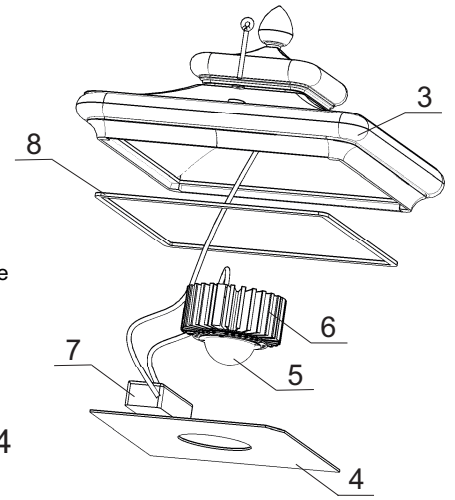

Mounting instruction:

- *)- Put the shade (2) into the basket (1)
- *)- Screw the radiator (6) to mount an LED light source to the disk (4)
- *)- Connect the electrical cables to the terminals of power supply (7)
- Screw tightly disk (4) to the luminary cover (3)
- Close the cover using hand.
- Luminary is mounted to the lantern depending on the pole construction - either hanging on M20 thread or mounted on the top of the pole on 45 - 90 diameter.

If any lantern elements are supplied factory-mounted, the mounting stages marked with *) should be omitted (as this has already been done by the manufacturer).

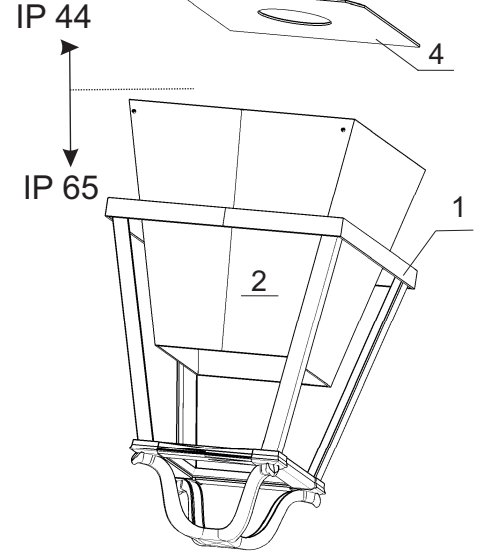

TECHNICAL DATA:

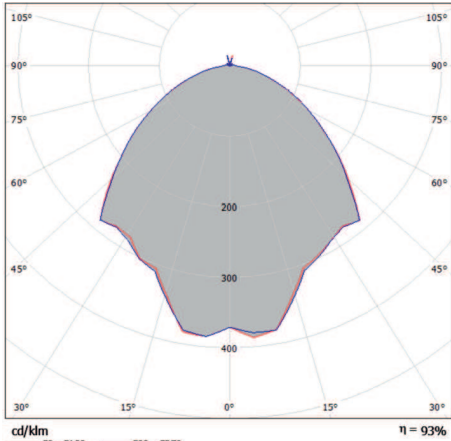

Photometry (polar plot)

Power: ~230/50Hz

Protective class: I

IP44 -electrical part

IP65 -optical part



ELECTRICAL DIAGRAM:

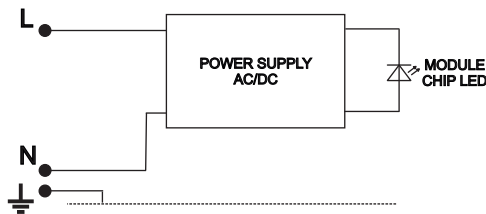

1.Module CHIP LED

Type	Light-prod. element	Lum.Flux [lm]	Light colour	Weight [kg]	Pn [W]	Luminary dimensions	
22L-30W	IL1M30W	3300	warm white	11,6	30		
22L-40W	IL1M40W	4400	warm white	11,6	40		
22L-50W	IL1M50W	5500	warm white	11,6	50		
22L-60W	IL1M60W	6600	warm white	11,6	60		
						<p>Wind aera A = 0,27m²</p>	<p>H/A 505/690</p>

WARNING !! The weight of the unit may slightly differ for individual production batches.

