

2024 Collection

Outdoor Lighting

DGA

Ariel IP67

Saturno IP67

Milli

Triuum IP67

Lui/Lei IP67 Solovetro





Ariel P IP67

Saturno P IP67

La Collezione completa l'universo di apparecchi già proposti da DGA per l'Outdoor. Una selezione di prodotti che guarda al design come punto di partenza e alla sostenibilità come punto di arrivo. Apparecchi con basso impatto ambientale, nell'ottica di un'economia circolare. La Collezione Outdoor è la risposta dell'azienda all'esigenza, sempre più diffusa, di un approccio più green all'illuminazione.

The Collection completes the universe of luminaires already offered by DGA for the Outdoor. A selection of products that looks at the design as a starting point and at the sustainability as the endpoint. Products with low environmental impact, in line with a circular economy perspective. The Outdoor Collection is the company's response to the increasingly widespread need for a greener approach to lighting.

Tecnologia Brevettata

Plug&Play System

Un cuore green, che pulsa.

A beating green heart.



Innovative patented technology

IT

Evolversi vuol dire semplificare. Con questo obiettivo è stata sviluppata l'innovativa tecnologia brevettata Plug&Play per l'intercambiabilità delle sorgenti LED sugli apparecchi. Un approccio inedito alla luce che agevola e velocizza le operazioni di montaggio, cambio e manutenzione delle sorgenti all'interno di qualsiasi progetto, indoor e outdoor. Il sistema Plug&Play offre la possibilità di riparare e sostituire i moduli LED, in qualsiasi fase del loro ciclo di vita, riducendo al minimo lo spreco di risorse e materiali. Una tecnologia che ridefinisce l'illuminazione in un'ottica sempre più sostenibile e circolare.

EN

Evolution means simplification. With this aim in mind, the innovative and patented Plug&Play technology has been developed for the interchangeability of LED light sources in the luminaires. An original approach to the lighting that facilitates and speeds up assembly, replacement, and maintenance operations of light sources within any indoor and outdoor project. The Plug&Play system offers the possibility to repair and replace the LED module at any stage of its lifecycle, minimizing the waste of resources and materials. This technology redefines the lighting with an increasingly sustainable and circular perspective.

PLUG & PLAY



Tecnologia Brevettata

Plug&Play System

Luce a favore dell'ambiente

Light for the environment





PLUG & PLAY

100%
Recyclable
Metal



Ariel P IP67 / Saturno P IP67

95%
Recyclable
LED Module
Metal



PLUG & PLAY

Color temperatures:
**2200K, 2400K, 2700K,
3000K, 3500K, 4000K**

90%
Recyclable
PMMA



Interchangeable lenses:
12°/14°, 18°, 24°, 33°, 52°

100%
Recyclable
Aluminum



Optical filters:
**Hex louver, Elliptical filter, Prismatic
filter, softening lens**

100%
Recyclable
Aluminum



Filter holder rings: **Satin Gold, Gold
Chrome, Shiny Chrome,
Satin Nickel, Black**

100%
Recyclable
Aluminum /Glass



Filter holder rings: **Bright Brown, Brown, Fir
Green, Anthracite Gray, Black, Gray, Gray white**

IT

Il Sistema brevettato Plug&Play garantisce:

- 1. Prodotti altamente riciclabili**
- 2. Design sostenibile**
- 3. Ciclo di vita degli apparecchi quasi infinito**
- 4. Massima flessibilità nella sostituzione del modulo LED e degli accessori**
- 5. Manutenzione semplice, intuitiva e immediata**

EN

The patented Plug&Play System ensures:

- 1. Highly recyclable products**
- 2. Sustainable design**
- 3. Almost infinite luminaire life cycle**
- 4. Maximum flexibility in replacing the LED module and accessories**
- 5. Simple, intuitive and immediate maintenance**





Outdoor Lighting Overview

Ariel IP67 Collection ↗ P. 16

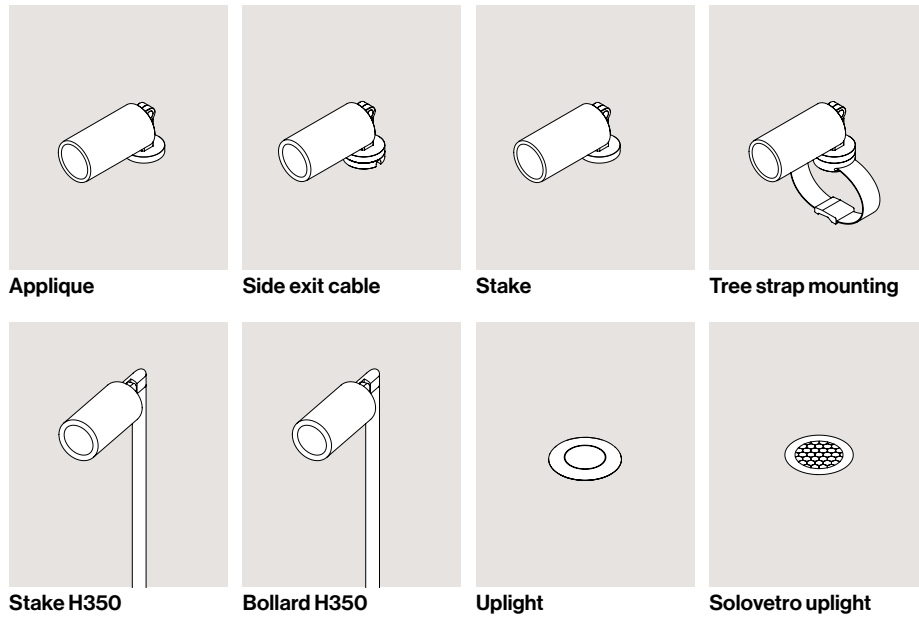

Saturno IP67 Collection ↗ P. 24

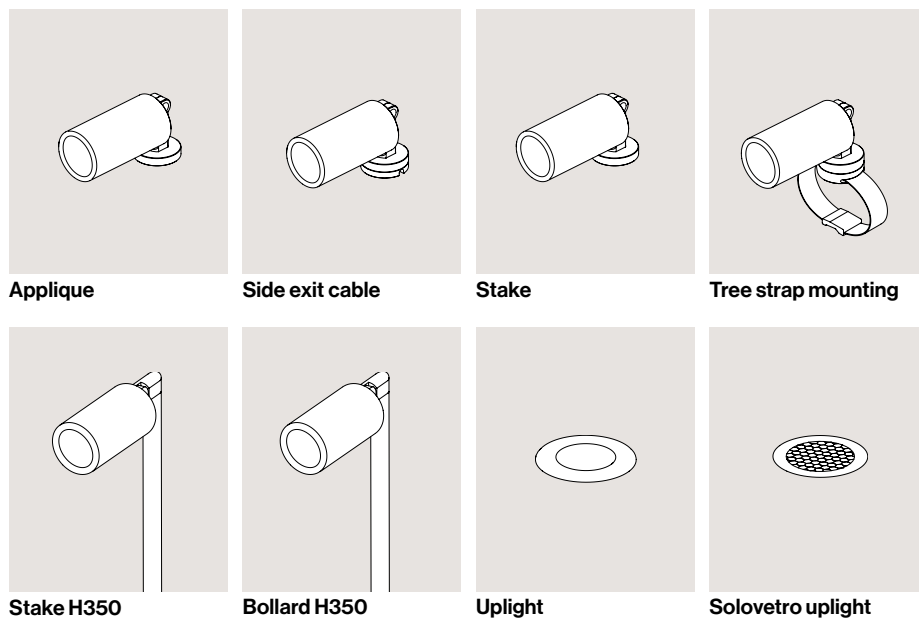

Milli Collection
↗ P. 32

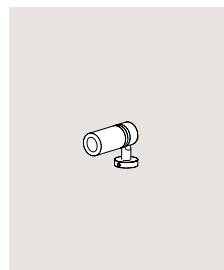

Applique

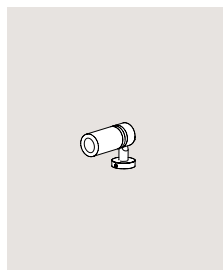

Stake

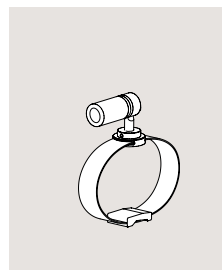

Tree strap mounting

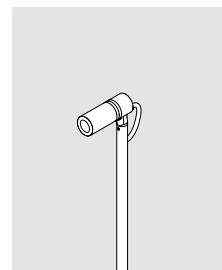

Stake H350



Bollard H350

Triuum IP67 Collection
↗ P. 38

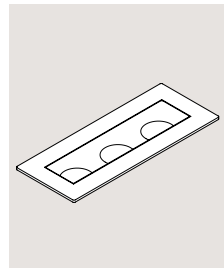

Uplight

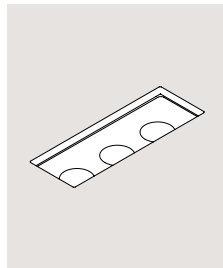

Solovetro uplight

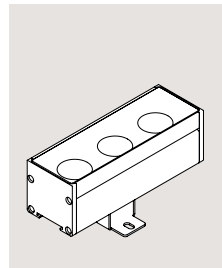

Applique

Lui / Lei IP67 Solovetro Collection
↗ P. 45

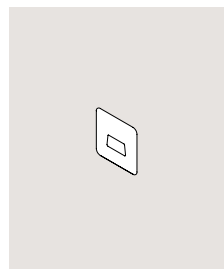

LUI 01 Steplight

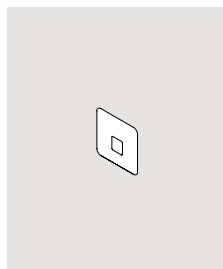

LUI 02 Steplight

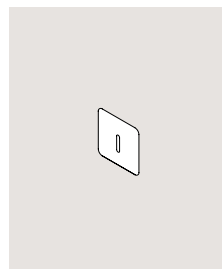

LUI 03 Steplight

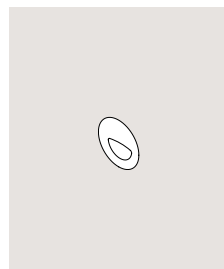

LEI 01 Steplight

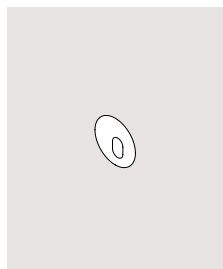

LEI 02 Steplight

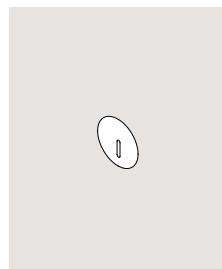

LEI 03 Steplight





Ariel IP67

Collection

ARIEL amplia la sua gamma con la versione outdoor (IP67) e con l'innovativo sistema Plug&Play. Su tutta la Collezione è possibile cambiare le lenti, i filtri ottici, gli anelli decorativi e la sorgente LED. La tecnologia brevettata Plug&Play, novità assoluta di ARIEL IP67, permette di modificare il modulo luminoso direttamente in loco, senza sostituire l'apparecchio e prolungandone il ciclo vitale. Una funzionalità importante, soprattutto in contesti complessi, e per tutte le versioni del prodotto: incasso, incasso Solovetro e proiettore.

ARIEL expands its range with the outdoor version (IP67) and the innovative Plug&Play system. Throughout the Collection, it is possible to change lenses, optical filters, decorative rings, and the LED light source.

The patented Plug&Play technology, a novelty of ARIEL IP67, allows to modify the light module directly on-site, without replacing the fixture and extending its life cycle.

This functionality is important, especially in complex contexts, and for all product versions: upright, Solovetro upright, and projector.











**Ariel IP67 Collection
Overview**

Uplight

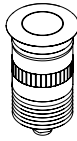

Solovetro uplight

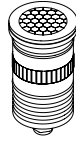

Ariel i IP67 / Ariel i IP67 Solovetro

Dimensions: Ø63 x 113, Ø59 x 116

9W

500mA

Ariel i IP67: 750lm output (3000K CRI>80)

Ariel i IP67 Solovetro: 550lm output (3000K CRI>80)

CRI>80, CRI>90

2200K, 2400K, 2700K, 3000K, 3500K, 4000K

Interchangeable lenses: 18°, 24°, 33°, 52°

Interchangeable plug&play modules: 2200K, 2400K, 2700K, 3000K, 3500K, 4000K

IP67

Finishes: Champagne Gold, Black, Gray, Stainless Steel AISI316L

Decorative rings: Satin Gold, Gold Chrome, Shiny Chrome, Satin Nickel, Black



Applique



Side exit cable



Stake

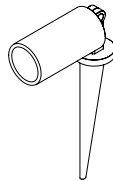

Ariel P IP67

Dimensions: Ø49 x 114

9W - 13W

500mA - 700mA

770lm output (3000K CRI>80), 1000lm output (3000K CRI>80)

CRI>80, CRI>90

2200K, 2400K, 2700K, 3000K, 3500K, 4000K

Interchangeable lenses: 18°, 24°, 33°, 52°

Interchangeable plug&play modules: 2200K, 2400K, 2700K, 3000K, 3500K, 4000K

IP67

Finishes: Bright Brown, Brown, Fir Green, Anthracite Gray, Black, Gray, Gray white

Decorative rings: Satin Gold, Gold Chrome, Shiny Chrome, Satin Nickel, Black



Tree strap mounting



Stake H350

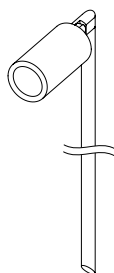

Bollard H350

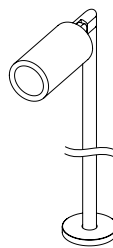

Bright Brown

Brown

Fir Green

Anthracite Gray

Black

Gray

Gray white





Saturno IP67

Collection

SATURNO, nella versione outdoor IP67, presenta un importante aggiornamento tecnologico: il sistema Plug&Play. Gli apparecchi, disponibili in tre configurazioni, incasso, incasso Solovetro e proiettore, sono tutti implementati con le nuove tecnologie ottiche DGA, ideate per semplificarne l'impiego e la manutenzione mantenendo inalterate le performance. Su SATURNO IP67 è possibile sostituire lenti, filtri ottici, anelli decorativi e la sorgente LED col sistema Plug&Play.

SATURNO, in the outdoor IP67 version, features a significant technological update: the Plug&Play system. The luminaires, available in three configurations - uplight, Solovetro uplight and projector - are all equipped with the new DGA optical technologies, designed to simplify their use and maintenance while maintaining the performances. On SATURNO IP67, it is possible to replace lenses, optical filters, decorative rings, and the LED light source thanks to the Plug&Play system.











**Saturno IP67 Collection
Overview**

Uplight

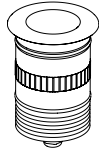

Solovetro uplight

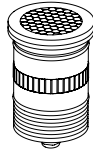

Saturno i IP67/Saturno i IP67 Solovetro

Dimensions: Ø85 x 127, Ø80 x 131

12W

350mA

Saturno i IP67: 1200lm output (3000K CRI>80)

Saturno i IP67 Solovetro: 920lm output (3000K CRI>80)

CRI>80, CRI>90

2200K, 2400K, 2700K, 3000K, 3500K, 4000K

Interchangeable lenses: 18°, 24°, 33°, 52°

Interchangeable plug&play modules: 2200K, 2400K, 2700K, 3000K, 3500K, 4000K

IP67

Finishes: Champagne Gold, Black, Gray, Stainless Steel AISI316L

Decorative rings: Satin Gold, Gold Chrome, Shiny Chrome, Satin Nickel, Black



Applique

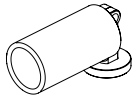

Side exit cable

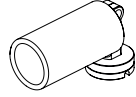

Stake

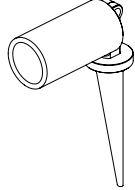

Saturno P IP67

Dimensions: Ø62 x 140

12W - 18W

350mA - 500mA

1250lm output (3000K CRI>80), 1700lm output (3000K CRI>80)

CRI>80, CRI>90

2200K, 2400K, 2700K, 3000K, 3500K, 4000K

Interchangeable lenses: 18°, 24°, 33°, 52°

Interchangeable plug&play modules: 2200K, 2400K, 2700K, 3000K, 3500K, 4000K

IP67

Finishes: Bright Brown, Brown, Fir Green, Anthracite Gray, Black, Gray, Gray white

Decorative rings: Satin Gold, Gold Chrome, Shiny Chrome, Satin Nickel, Black



Tree strap mounting

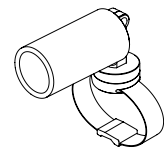

Stake H350

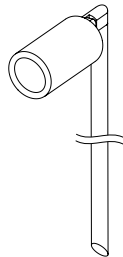

Bollard H350

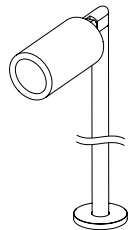

Stainless Steel AISI 316 L

Gray

Black





Milli

Collection

MILLI è il nuovo microproiettore outdoor, un apparecchio molto versatile e performante dalle dimensioni estremamente compatte. Sono previsti 5 sistemi di fissaggio: applique, picchetto, picchetto H350, cinghia per alberi e bollard. Le ottiche sono definite da un'unica potenza (2,5W) e quattro aperture: 10°, 25°, 40° e 60°. Il vetro a filo e l'ottica arretrata evitano ogni abbagliamento e dispersione laterale. Allo stesso modo, la staffa orientabile dirige puntualmente il fascio luminoso. Le nuove finiture rendono Milli perfettamente mimetizzabile negli ambienti naturali.

MILLI is the new outdoor micro-projector, a very versatile and high-performing fixture with extremely compact dimensions. It includes 5 fixing systems: wall-mounted, stake, H350 stake, tree strap, and bollard. The optics are characterized by a single power (2.5W) and four beam angles: 10°, 25°, 40°, and 60°. The flush glass and recessed optic prevent glare and side dispersion, while the adjustable bracket precisely directs the light beam. The new finishes make Milli perfectly camouflageable in natural environments.







Milli Collection Overview

Applique



Stake

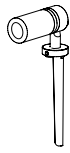

Tree strap mounting



Stake H350



Bollard H350

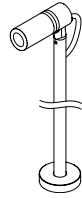

Milli

Dimensions: Ø20 x 49

2,5W

700mA

120lm output (3000K CRI>90)

CRI>80, CRI>90

2200K, 2700K, 3000K, 3500K, 4000K

Lenses: 10°, 25°, 40°, 60°

IP67

Finishes: Massive Brass, Bright Brown, Fir Green, Black, Gray, Stainless steel AISI316L







Triuum IP67

Collection

TRIUUM è l'evoluzione dell'incasso lineare. Le dimensioni compatte e le prestazioni elevate ne fanno la perfetta soluzione per illuminare i dettagli architettonici ed esaltarne i materiali. Le ottiche proposte, tra cui il versatile wall-washer, facilitano il dialogo tra l'edificio e la luce, integrandosi ed esaltandosi a vicenda.

TRIUUM è presentato in tre configurazioni: incasso, incasso Solovetro e proiettore con staffe. Nella versione ad incasso, grazie alla sottilissima flangia in acciaio, l'apparecchio si integra perfettamente nella pavimentazione. La variante Solovetro, a filo superficie, è quasi invisibile e lascia emergere solo la luce in tutta la sua eleganza. Su staffa è l'ideale per i contesti outdoor più delicati.

TRIUUM is the evolution of linear recessed lighting. Its compact dimensions and high performance make it the perfect solution for enlightening architectural details and enhancing the materials. The proposed optics, including the versatile wall-washer, facilitate the dialogue between the building and the light, integrating and enhancing each other.

TRIUUM is presented in three configurations: upright, Solovetro upright and projector with brackets. In the recessed version, thanks to the super-thin stainless-steel bezel, the product integrates perfectly into the floor. The Solovetro variant, surface-flush, is almost invisible and reveals only the light in all its elegance. When mounted on a bracket, it is ideal for delicate outdoor settings.







**Trium IP67 Collection
Overview**

Uplight

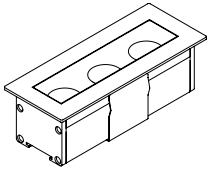

Solovetro uplight

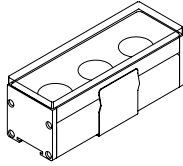

Trium i IP67/ Trium i IP67 Solovetro

Dimensions: 150 x 60 x 48, 137 x 47 x 53

7W-15W

24Vdc

600lm output (3000K CRI>80)
1000lm output (3000K CRI>80)

CRI>80, CRI>90

2200K, 2700K, 3000K, 3500K, 4000K
(RGBW and Tunable White versions soon available)

Lenses: 10°, 25°, 40°, 60°, Elliptical lens, Wall washer

IP67

Finishes: Brushed Stainless steel AISI 316L, Black



150 x 60 x 62, 137 x 47 x 68

8W

220-240 Vac

600lm output (3000K CRI>80)

CRI>80, CRI>90

2200K, 2700K, 3000K, 3500K, 4000K

Lenses: 10°, 25°, 40°, 60°, Elliptical lens, Wall washer

IP67

Finishes: Brushed Stainless steel AISI 316L, Black



Adjustable bracket H30

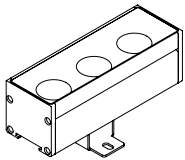

Adjustable bracket H50

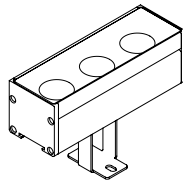

Trium P IP67

Dimensions: 137 x 47 x 56

7W-15W

24Vdc

600lm output (3000K CRI>80)
1000lm output (3000K CRI>80)

CRI>80, CRI>90

2200K, 2700K, 3000K, 3500K, 4000K
(RGBW and Tunable White versions soon available)

Lenses: 10°, 25°, 40°, 60°, Elliptical lens, Wall washer

IP67

Finish: Black



137 x 47 x 70

8W

220-240 Vac

600lm output (3000K CRI>80)

CRI>80, CRI>90

2200K, 2700K, 3000K, 3500K, 4000K

Lenses: 10°, 25°, 40°, 60°, Elliptical lens, Wall washer

IP67

Finish: Black

Adjustable bracket H80

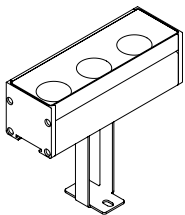

Fixing plate

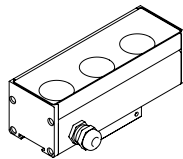

Without louver

With louver

With asy louver





Lui/Lei IP67 Solovetro

Collection

I segnapasso della collezione LUI e LEI si evolvono aggiornandosi sia nella tecnologia sia nell'estetica. Con il restyling di queste famiglie, DGA propone soluzioni tecniche inedite dalle elevate prestazioni e un appeal unico facilmente riconoscibile.

LUI è caratterizzato dal frontale quadrangolare ad angoli arrotondati. LEI è definito da un'essenziale forma circolare. Entrambi gli apparecchi sono installabili in appoggio e, grazie alla speciale controcassa trimless, a filo parete. Soluzione che permette una perfetta integrazione sulla parete, lasciando emergere solo una luce perfettamente direzionata. LUI e LEI, per le dimensioni contenute (35 mm) e l'elegante estetica Solovetro, sono estremamente versatili e adattabili ad ogni contesto, anche il più complesso.

LUI and LEI step light collections evolve by updating both its technology and aesthetics. With the restyling of these families, DGA proposes innovative technical solutions with high performance and a unique, easily recognizable appeal. LUI is characterized by a square front panel with rounded corners. LEI is defined by an essential circular shape. Both luminaires can be installed surface-mounted and, thanks to the special trimless recessed box, flush with the wall. This solution allows for a perfect integration within the wall, revealing only a perfectly directed light. Thanks to their compact size (35 mm) and elegant Solovetro aesthetics, LUI and LEI are extremely versatile and adaptable to any context, even the most complex.







Lui/Lei IP67 Solovetro Collection Overview

Lui 01
Steplight

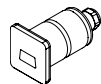

Lui 02
Steplight

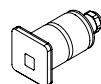

Lui 03
Steplight

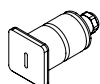

LUI IP67 Solovetro

Dimensions: 35 x 35 x 65

1W-2W

350mA-500mA

15lm output (3000K CRI>80) - 20lm output (3000K CRI>80)

CRI>80

2200K, 2700K, 3000K, 4000K

Lense: 45° asymmetrical

IP67

Finishes: White, Gray, Black



Lei 01
Steplight

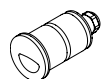

Lei 02
Steplight

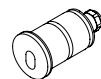

Lei 03
Steplight

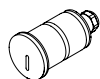

LEI IP67 Solovetro

Dimensions: Ø35 x 65

1W-2W

350mA-500mA

15lm output (3000K CRI>80) - 25lm output (3000K CRI>80)

CRI>80

2200K, 2700K, 3000K, 4000K

Lense: 45° asymmetrical

IP67

Finishes: White, Gray, Black



DGA S.p.A.

Sede Legale e Amministrativa
Via Pietro Nenni, 72/B
50013 Campi Bisenzio (FI) Italy
T. +39 055 8986235
F. +39 055 8986243

Milano Showroom
Corso Monforte, 23
20122 Milano (MI) Italy
T. +39 02 25064156
milanoshowroom@dga.it

Contact

Unità Produttiva
Via Gattinella, 18
50013 Campi Bisenzio (FI) Italy
T. +39 055 5391520

Export Sales Department
T. +39 055 8945892
export@dga.it

Ufficio Vendite Italia
T. +39 055 8986235
commerciale@dga.it

Consulenza e Progettazione Illuminotecnica
T. +39 055 8986235
lighting@dga.it

Assistenza Tecnica
T. +39 055 8986235
ufficiotecnico@dga.it

Ufficio Comunicazione
T. +39 055 8986235
communication@dga.it

dga.it